

# FASER 5xL

Tassello a battere per cemento

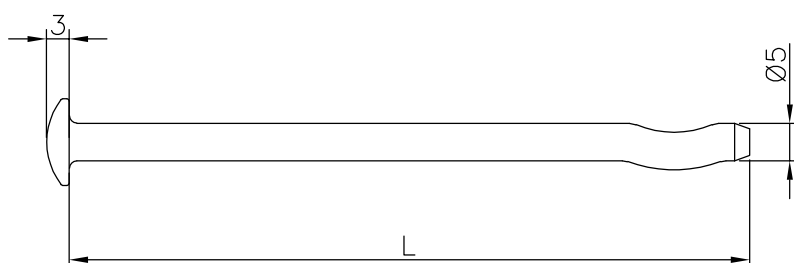

MATERIALE: Acciaio C35  
TRATTAMENTO: Bonifica  
RIVESTIMENTO: Geomet

SCALA: 1:1  
FIRMA: Alberto B. T.  
DATA: 03/11/2020

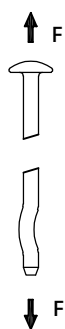

**Rottura  
in Trazione**

**16000 N**

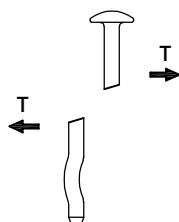

**Rottura  
al Taglio**

**9000 N**

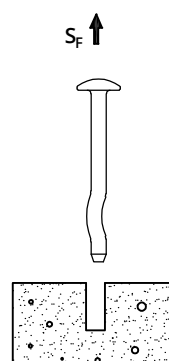

**Sfilamento da CLS  
prof. foro 30 mm**

Rck	$S_F$
25	<b>2470 N</b>
50	<b>3343 N</b>

N=Newton 1N ~ 0.102 kgf - I valori indicati rappresentano il valore caratteristico derivante dalle diverse sessioni di prove